

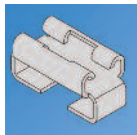

**THE DATASHEET OF**  
**3528**



# PC QUICK-FIT FEMALE TERMINALS



**ACCEPTS .110 (2.8) × .032 (.81) TAB**

**SMT - HORIZONTAL ENTRY**

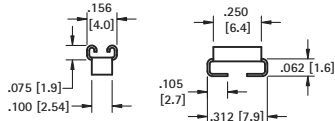

**SPECIFICATIONS**

**Material:** .012 (.30) Brass, Tin-Nickel Plate  
**Current Rating:** 15 Amps @ 500V AC

**CAT. NO. 3569\*** (Bulk)

**CAT. NO. 3569TR\*** (Tape & Reel)

**Tape & Reel Spec's:** 24mm wide, 8mm pitch, 13 inch reel (2000 pieces per reel)

**Mounting Detail**

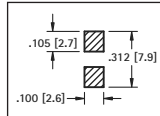

**ACCEPTS ALL TABS**

.110 (2.8) TO .50 (6.4) × .020 (.50) TO .032 (.80)

**SMT - VERTICAL OR HORIZONTAL ENTRY**

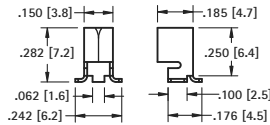

**SPECIFICATIONS**

**Material:** .016 (.40) Brass, Tin-Nickel Plate  
**Current Rating:** 15 Amps @ 500V AC

**CAT. NO. 3586\*** (Bulk)

**CAT. NO. 3586TR\*** (Tape & Reel)

**Tape & Reel Spec's:** 16mm wide, 12mm pitch, 13 inch reel (750 pieces per reel)

**Mounting Detail**

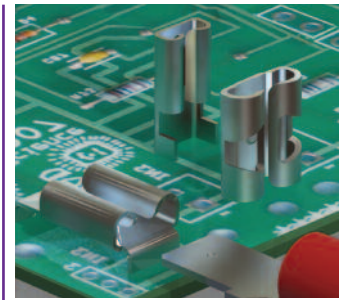
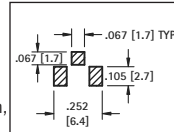

**Underwriters Laboratories, Inc.**  
**Recognized Component Program**  
 — UL File Number E201546

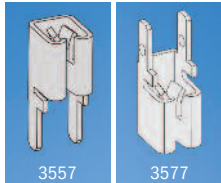

**ACCEPTS ALL TABS**  
 .110 (2.8) TO .50 (6.4) × .020 (.50) TO .032 (.80)

**VERTICAL OR HORIZONTAL ENTRY**

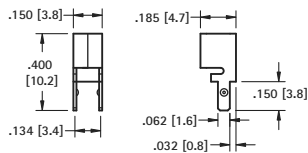

**MATERIAL:**

.016 (.41) Brass, Tin-Nickel Plate

| CAT. NO. | ORIENTATION      |
|----------|------------------|
| 3557     | top & side entry |
| 3577*    | bottom entry     |

**Mounting Detail**  
 Cat. No. 3557

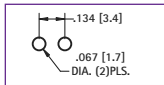

**Mounting Detail**  
 Cat. No. 3577

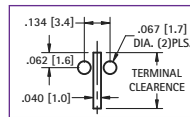

**ACCEPTS .187 (4.8), .205 (5.2), .250 (6.4) TAB**

**HORIZONTAL ENTRY**

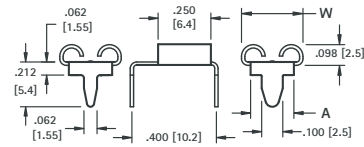

**MATERIAL:** Brass, Tin-Nickel Plate

| CAT. NO. | ACCEPTS TAB           | "W"        | "A"        | MATL THICK |
|----------|-----------------------|------------|------------|------------|
| 3571     | .187(4.8) × .020(.51) | .222 (5.6) | .162 (4.1) | .012 (.30) |
| 3572*    | .187(4.8) × .032(.81) | .222 (5.6) | .162 (4.1) | .012 (.30) |
| 3546     | .205(5.2) × .020(.51) | .240 (6.1) | .180 (4.6) | .012 (.30) |
| 3550     | .205(5.2) × .032(.81) | .240 (6.1) | .180 (4.6) | .012 (.30) |
| 3547     | .250(6.4) × .032(.81) | .291 (7.4) | .205 (5.2) | .016 (.41) |

**Mounting Detail**

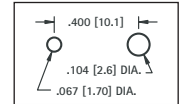

**ACCEPTS .110 (2.8) TAB**

**HORIZONTAL ENTRY**

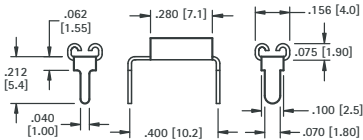
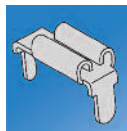

**MATERIAL:**

.012 (.30) Brass, Tin-Nickel Plate

| CAT. NO. | ACCEPTS TAB             |
|----------|-------------------------|
| 3545     | .110 (2.8) × .020 (.51) |
| 3549     | .110 (2.8) × .032 (.81) |

**Mounting Detail**

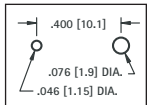

**ACCEPTS .110 (2.8) TAB**

**VERTICAL ENTRY**

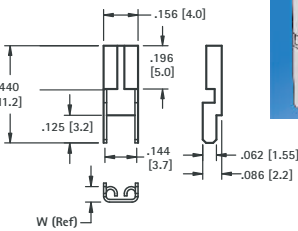
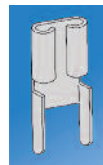

**MATERIAL:**

.012 (.30) Brass, Tin-Nickel Plate

| CAT. NO. | ACCEPTS TAB           | W           |
|----------|-----------------------|-------------|
| 3534     | .110(2.8) × .020(.51) | .070 (1.80) |
| 3544     | .110(2.8) × .032(.81) | .075 (1.92) |

**Mounting Detail**

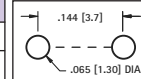

**ACCEPTS .187 (4.8) TAB**

**VERTICAL ENTRY**

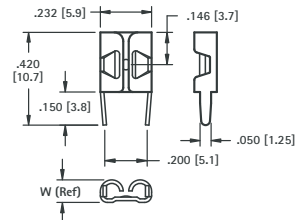
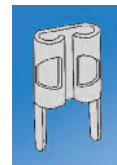

**MATERIAL:** .016 (.41) Brass, Tin-Nickel Plate

| CAT. NO. | ACCEPTS TAB           | "W"         |
|----------|-----------------------|-------------|
| 3548     | .187(4.8) × .020(.51) | .093 (2.36) |
| 3578*    | .187(4.8) × .020(.51) | .093 (2.36) |
| 3551     | .187(4.8) × .032(.81) | .102 (2.59) |

**Mounting Detail**

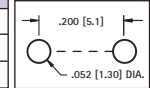

\*Low insertion force design

**ACCEPTS .205 (5.2) TAB**

**VERTICAL ENTRY**

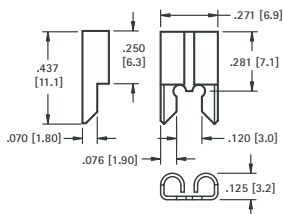
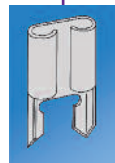

**MATERIAL:**

.016 (.41) Brass, Tin-Nickel Plate

| CAT. NO. | ACCEPTS TAB             |
|----------|-------------------------|
| 3525     | .205 (5.2) × .020 (.51) |
| 3575*    | .205 (5.2) × .032 (.81) |

**Mounting Detail**

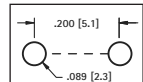

**ACCEPTS .250 (6.4) TAB**

**VERTICAL ENTRY**

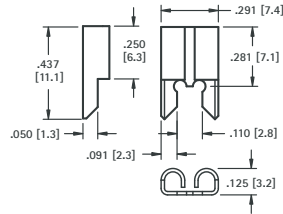
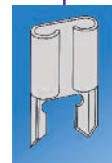

**MATERIAL:**

.016 (.41) Brass, Tin-Nickel Plate

| CAT. NO. | ACCEPTS TAB             |
|----------|-------------------------|
| 3528     | .250 (6.4) × .032 (.81) |

**Mounting Detail**

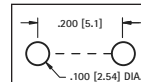

**ACCEPTS .312 (7.9) TAB**

**OVER SIZED**

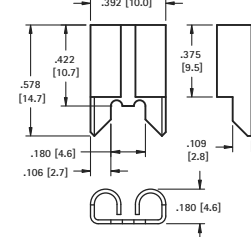
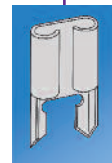

**MATERIAL:**

.020 (.51) Copper, Tin-Nickel Plate

**CAT. NO. 3555**

**Mounting Detail**

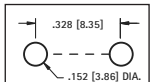

\* Not UL Recognized

## Looking for pricing, stock, or lifecycle information?

Click below to explore more details on WIN SOURCE:

- ⊖ [View 3528 on WIN SOURCE](#)
- ⊖ [Keystone Electronics Information](#)

## Optimize Your Supply Chain with WIN SOURCE Solutions

- ✓ Global Sourcing Solution
- ✓ Obsolete Management
- ✓ Cost Control Management
- ✓ Shortage Management
- ✓ Alternative Solution
- ✓ Excess Inventory Management